

ORDINANCE NO. 2000-1

AN ORDINANCE OF THE CITY COMMISSION OF THE CITY OF CUMBY, TEXAS, ANNEXING PUBLIC RIGHT OF WAY TO THE CITY; EXTENDING THE BOUNDARY LIMITS OF THE CITY SO AS TO INCLUDE SAID AREA; GRANTED TO OTHER AREAS WITHIN THE CORPORATE LIMITS OF THE CITY; AND PROVIDING THAT THIS ORDINANCE SHALL BE IN FULL FORCE AND EFFECT IMMEDIATELY UPON ITS PASSAGE AND APPROVAL.

WHEREAS, the City of Cumby, Texas has determined that the annexation of certain publicly owned right of way adjacent to the corporate limits of the City and coming within the extra territorial jurisdiction of the City should by, in the interest of public convenience and benefit, annexed by the City so that said areas will thereafter be a part of and included within the corporate limits of the City.

NOW, THEREFORE, BE IT ORDAINED by the City Commission of the City of Cumby, Texas:

SECTION ONE: The areas of real property within the public right of way of the following publicly owned highways, from the intersection of said public right of way with the corporate limits of the City and extending for a distance shown in exhibit "A". The present corporate limits of the City shall be and the same are hereby annexed to the City of Cumby, Texas, and the corporate limits of said City are hereby extended to incorporate and include said tracts of said property within the corporate limits of the City, and said areas of real property shall hereafter be entitled to all rights and privileges of the City of Cumby, Texas, and shall hereafter be bound by the acts, ordinances, resolutions, and regulations of the City, to wit:

Interstate Hwy. 30 East and West from the corporate limits of the City;
The North and South service roads of Interstate Hwy. 30 East and West from the corporate limits of said City;

Highway 275 in a Northerly and Southerly direction from the corporate limits of said city;

Highway 499 in a Westerly direction from the corporate limits of said City; and an Easterly direction from the corporate limits of the City to the intersection of Interstate 30.

SECTION TWO: This ordinance shall be in full force and effective immediately upon its passage and approval.

PASSED, APPROVED AND ADOPTED THIS THE 17th DAY OF August, 2000.

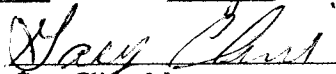
Gary Clinic, Mayor

ATTEST::



City Secretary

EXHIBIT "A"

Non-Controlled Access Highway

- I. State Maintained: (base, surface, structures, and assist in mowing, clean up litter, sweeping, and maintenance of roadway ditches).
 - A. FM Highway 275: From the junction with FM 499 (Sta 0+09) Northerly to (Sta 184+14)
 - B. FM Highway 275: From the junction with Interstate 30 (Sta. 61+07) Southerly to (Sta 142+88)
 - C. FM Highway 499: From the Hunt County Line (Sta 0+00) to the Intersection of Interstate 30 (Sta 3+49)

EXHIBIT "B"

Controlled Access Highway

- I. State Maintained:
 - A. Interstate Highway 30: From the junction at Hunt County Line (Sta 725+48) to east City limit at (Sta 917+00) East and West Bound

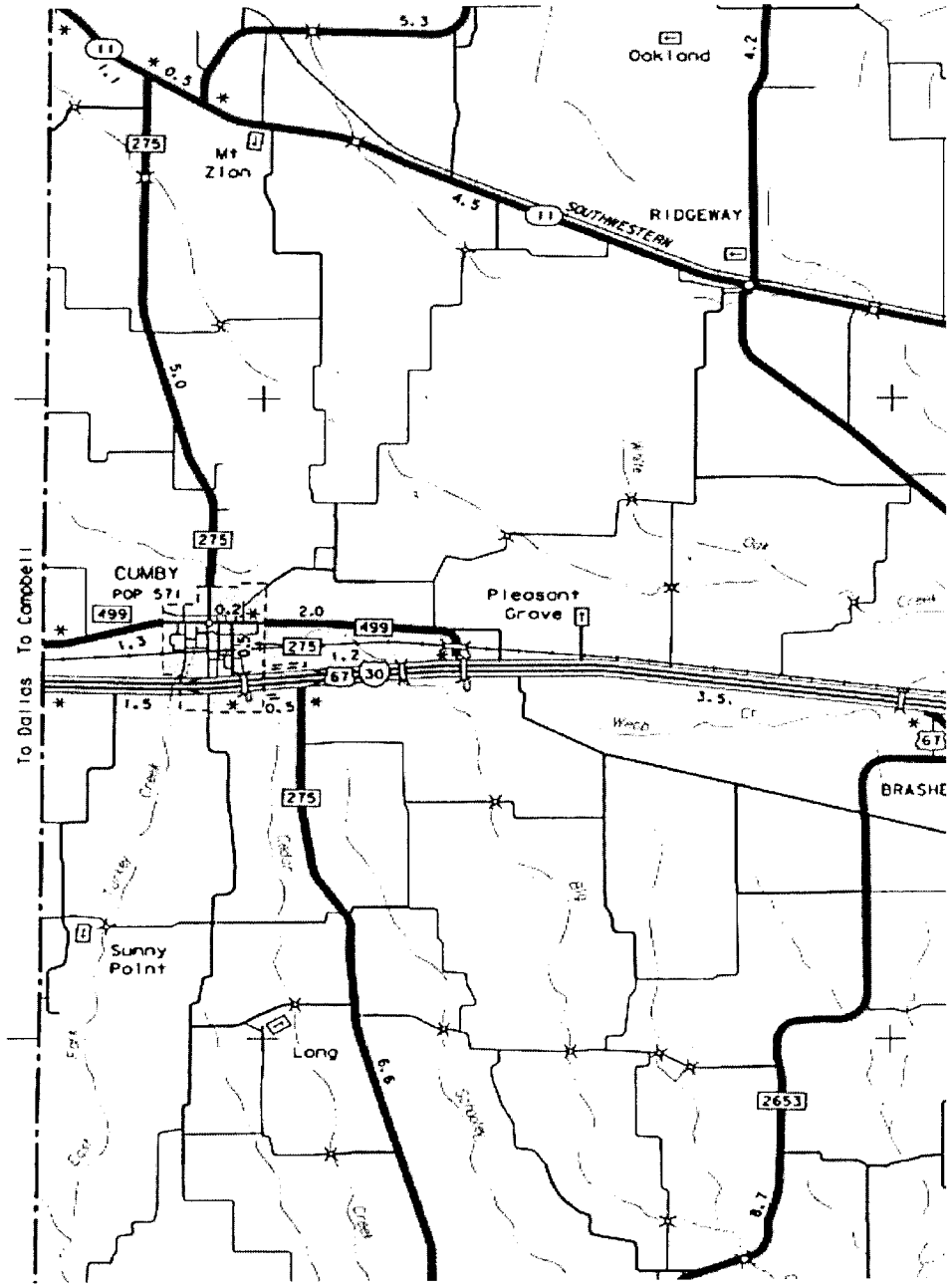

U

O

C

To Dallas To Campbell

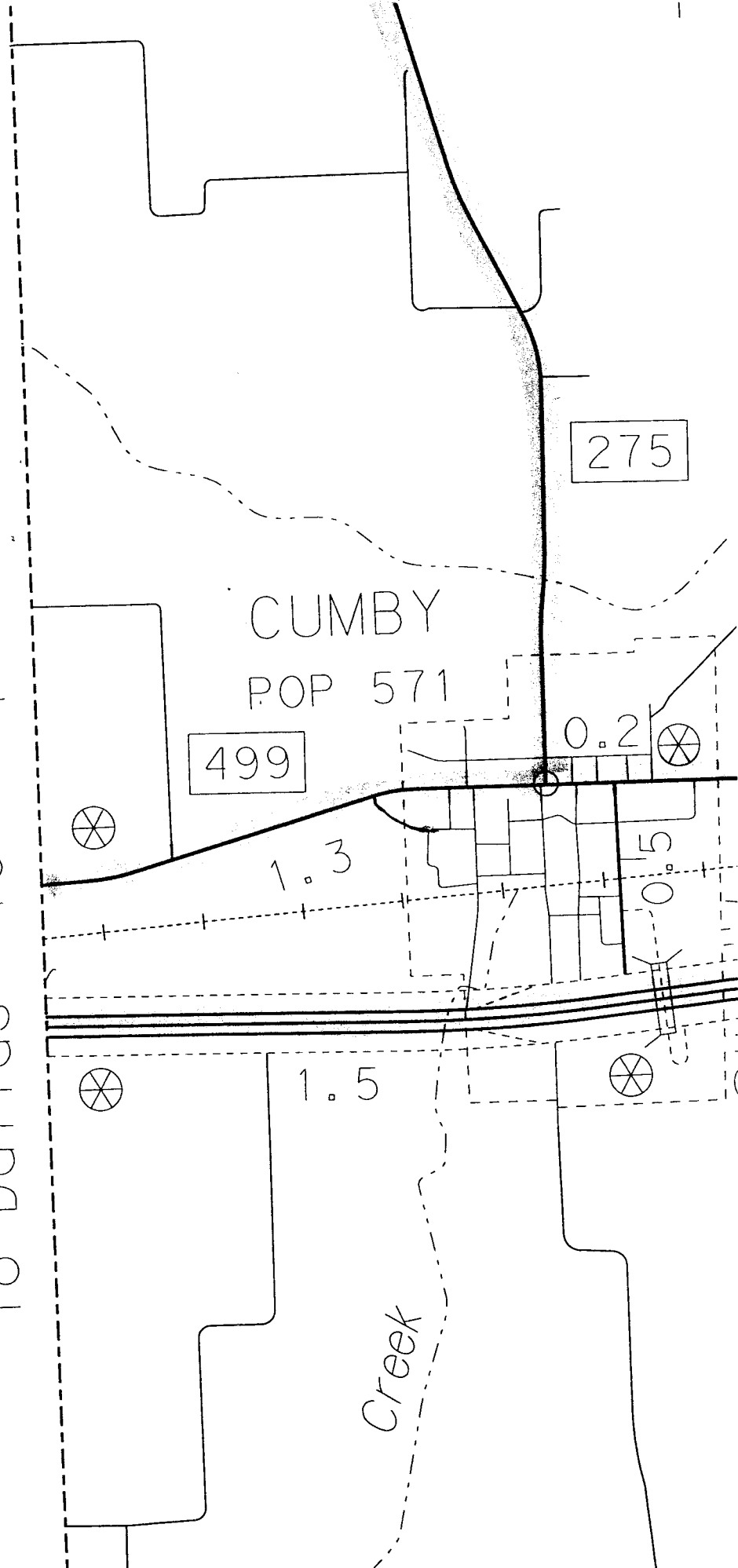

White

Pleasant
Grove

499

.0

1.2

5

Webb

275

